

pipetman®

L

Precision, Comfort, and Reliability Engineered for Everyday Lab Performance

PIPETMAN® L is designed to reduce hand fatigue and increase productivity. Its lightweight, perfectly balanced design and low pipetting forces help you stay focused, even during long pipetting sessions.

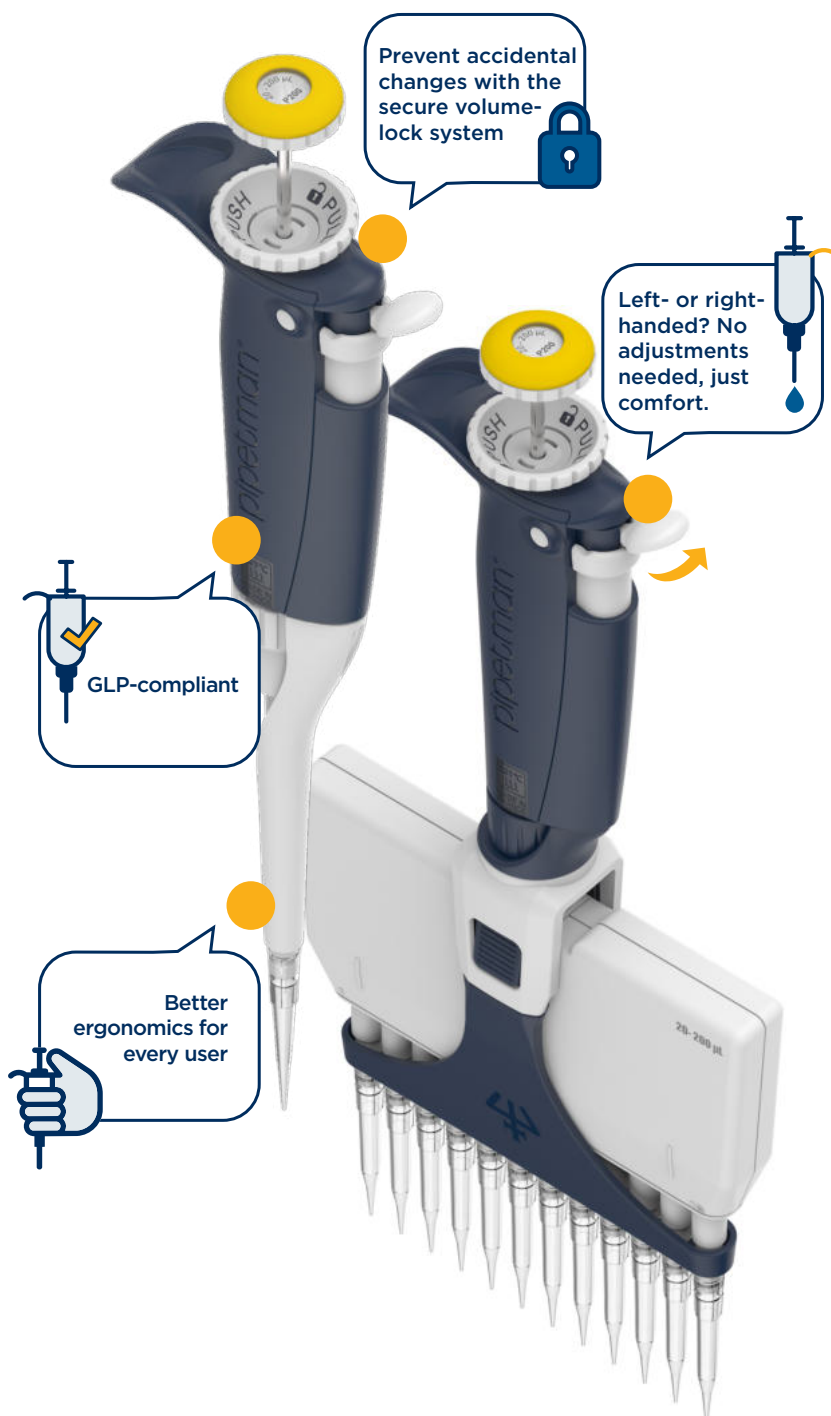

Work Longer Without Fatigue

- Reduced risk for RSIs
- More consistent results over time
- Higher daily throughput

Confidence in Every Pipetting Step

- Reliable, reproducible results you can trust
- Secure volume locking to prevent accidental changes
- Confidence when it matters most in critical experiments
- Fully autoclavable for better protection against cross-contamination

The Right Solution for Every Task

- Broad volume range: 0.2 μ L to 10 mL in single channel models
- Multichannel options up to 1200 μ L for flexible protocol support
- Fixed-volume models for consistent, repeatable tasks
- Multichannel V-ring design on select models enhances tip fit across most brands



An ideal solution for Biotechs, clinical labs, and high-intensity routine environments

 **GILSON®**

PIPETMAN L Single Channel — Variable Volume Models				
Model	PIPETMAN® DIAMOND Tips		Part Number	Volume (µL)
P2L	D10 DL10	DF10ST DFL10ST	FA10001P	0.2 - 2
			FA10001M	
P10L	D10 DL10	DF10ST DFL10T	FA10002P	0.5 - 10
			FA10002M	
P20L	D200	DF30ST	FA10003P	2 - 20
			FA10003M	
P100L	D200	DF100ST	FA10004P	10 - 100
			FA10004M	
P200L	D200 D300	DF200ST DF300ST	FA10005P	20 - 200
			FA10005M	
P1000L	D1000 D1200	DF1000ST DF1200ST	FA10006P	100 - 1000
			FA10006M	
P5000L	D5000		FA10007	500 - 5000
P10mLL	D10mL		FA10008	1000 - 10000



SCAN ME!

Ready to upgrade your pipetting experience?

*For a pipette with a plastic tip ejector, the part number ends with the letter P. For a pipette with a stainless steel tip ejector, the part number ends with the letter M, from P2L to P1000L.

PIPETMAN L Multichannel Models				
Model	PIPETMAN® DIAMOND Tips		Part Number	Volume (µL)
P8x10L	D10 DL10	DF10ST DFL10ST	FA10013	0.5 - 10
P12x10L			FA10014	
P8x20L	DL10 D200	DFL10ST DF30ST	FA10009	2 - 20
P12x20L			FA10010	
P8x200L	D200 D300	DF200ST DF300ST	FA10011	20 - 200
P12x200L			FA10012	
P8x200LVR**	D200 D300	DF200ST DF300ST	FA10035	20 - 200
P12x200LVR**			FA10036	
P8x300L	D200 D300	DF200ST DF300ST	FA10015	20 - 300
P12x300L			FA10016	
P8x300LVR**	D200 D300	DF200ST DF300ST	FA10037	20 - 300
P12x300LVR**			FA10038	
P8x1200L	D1200	DF1200ST	FA10039	100 - 1200
P12x1200L			FA10040	



**Models equipped with V-rings.

PIPETMAN® L KITS				
Model	Part Number	PIPETMAN L Models	PIPETMAN® DIAMOND Tips	Accessories
PIPETMAN L Starter Kit	F167350	P20L P200L P1000L	D200 D1000	3 SINGLE™ pipette holders 3 plastic ejectors
PIPETMAN L Micro-volume Kit	F167550	P2L P10L P100L	DL10 D200	3 SINGLE™ pipette holders 3 plastic ejectors
PIPETMAN L 4-Pipette Kit	F167370	P2L P20L P200L P1000L	DL10 D200 D1000	4 SINGLE™ pipette holders 4 Plastic ejectors

Choose your Tip Ejector

For single channel models, choose between a model with a stainless-steel tip ejector or a plastic ejector* depending on your needs and applications.

Large volume models are equipped with a plastic tip ejector to avoid any direct contact with the tip.

Choose Your Model

For routine testing applications, PIPETMAN L is available in fixed-volume models*** from 1 µL to 5 mL, helping reduce the risk of volume errors and ensure consistent results. With the same lightweight, ergonomic design, it's a reliable choice even for non-trained lab technicians.

***PIPETMAN L Fixed models are not fully autoclavable.

PIPETMAN L single channel models are available in kits, offering the essential pipetting tools to start an experiment right away.



PIPETMAN DIAMOND® Tips are designed to fit your PIPETMAN perfectly and guarantee maximum accuracy and precision.

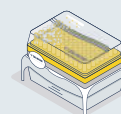

For ordering information, visit www.gilson.com

gilson.com/contactus

LT800606/C | ©2026 Gilson S.A.S.
All rights reserved. All trademarks are the property of Gilson, Inc. and its subsidiaries.

GILSON®